



* Some of the photos may include optional equipment.

HYUNDAI MATERIAL HANDLING Applied Tier 3 Engine

70/80D-7E ACE



www.hyundai-mh.com

2023.07



New criteria of forklift trucks

Hyundai introduces a new line of **ACE series diesel forklift trucks**.
Excellent power and performance make your business more profitable.



Excellent



HMC D4DD engine



Up-to-date cooling system



High-output air conditioner

* Some of the photos may include optional equipment.

The new master on the job-site!

Smooth running, efficient and ergonomically designed, **70/80D-7E ACE series** are made to meet your needs.



HMC D4DD Engine

Powerful engine

Market approved quality of HMC D4DD engine ensures incomparable performance, durability and excellent fuel efficiency. This engine meets EPA Tier-III and EU stage III A emission regulations.

73.5kW / 2,300rpm

38kgf.m/1,600rpm

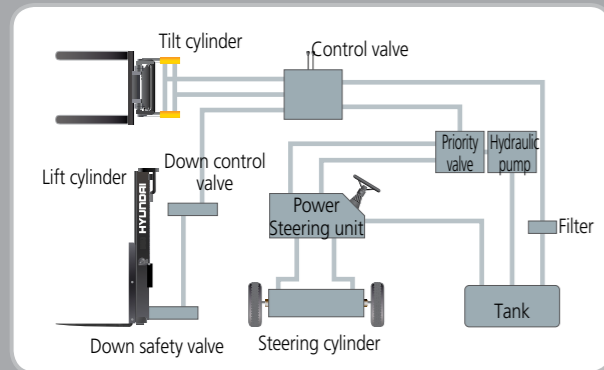

State-of-the-art hydraulic system

The latest large-capacity hydraulic system reacts quickly during operation, and a low-noise control valve increases both efficiency and durability.



* Some of the photos may include optional equipment.



Increased mast tilting angle

The mast tilting angle of 15 degrees forward and 10 degrees backward, the operator can safely and rapidly perform loading and unloading jobs.



Wet disc brake system

The wet disc brake system is virtually maintenance free and is enclosed to protect from dust and water.



Fully hydrostatic power steering

A hydraulic steering always guarantees smooth and flexible steering, preventing overrun and kick-back.



Key-locking fuel filler

Increased security on job sites with locking fuel cap, plus an increased capacity fuel tank for less down time.

Faster travel speed & gradeability

The powerful high-output engine provides greater acceleration, better gradeability and faster travel speed on any tough terrain or slope.



Travel speed (Unloaded)

70D-7E ACE : 33.8km/h

80D-7E ACE : 35.0km/h

Gradeability (Loaded)

70D-7E ACE : 42.4%

80D-7E ACE : 36.1%

Ergonomic operator friendly compartment design!

Smooth running, efficient and ergonomically designed, **70/80D-7E ACE series** are made to meet your needs.

Operator friendly gauges and water-resistant monitor panel



USB MP3 player



Grammer seat (option)

An attractive and adjustable seat, based on a human engineering design, provides great comfort. And the angle of the armrest can be adjusted to reduce the fatigue of the driver.

- Applied the weight of the driver(45~170kg)
- ELR type seat belt standard
- Heater and Head Rest (Option)



High-output air conditioner & heater



Multi key option



* Some of the photos may include optional equipment.



Rear view camera

The rear view camera makes the operation more easy and convenient. (Option)



Load Indicator

A load can be placed on the fork and can be accurately weighed by measuring the hydraulic pressure. (Option)



Quick response of operating control levers

Only minimal operator's effort is required for precise, safe and productive control.(std 2spool)



Adjustable steering wheel

Steering wheel with horn button can be adjusted by a lever on the right-hand side for the most comfortable operator position.



Easy and safe shift lever

A single lever on the left side of the steering column gives the operator fast, easy control of direction. The lever must be in the neutral position before the engine can be started.



Multi-function switch lever

Multi-functional switch lever gives easy access to lights and horn.



Ergonomically positioned pedals

Based on human engineering, the accelerator, brake and inching pedals are optimally positioned for convenience while operating the equipment.



Parking lever

Using the type of car parking lever, it is easy to control. You can safely parking, even so inclined.

Enhanced safety through high durability!

Safety and durability are priorities in the design of the equipment.

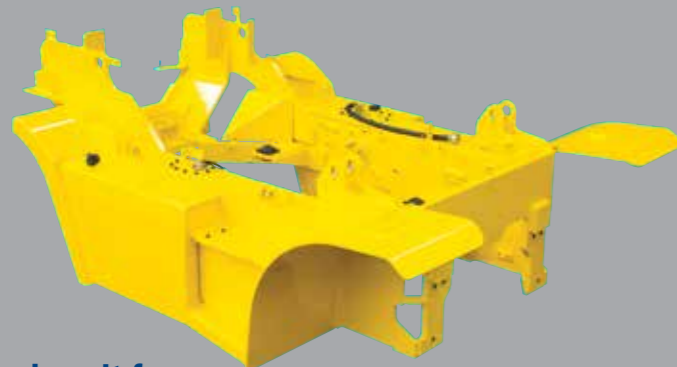

Heavy duty single unit frame

Heavy duty single unit type frame, designed on the basis of accurate structural analysis, guarantees durability and safety.



Highly durable split type drive axle

The durable drive axle provides fast travel speed and quiet travel under any heavy load condition, and boosts work efficiency.



ZF Full-automatic transmission

Full-automatic transmission gives easy, convenient handling and soft, smooth shifting. The operator can select two kinds of automatic mode.



* Some of the photos may include optional equipment.



Aluminum radiator and coolers

Aluminum radiator and coolers have been applied to increase the durability and heat output.



Large footboard & hand grip

Wide "open" step offers convenience and safety when entering and exiting truck.



Rearview mirror size increases

150% increase in the rearview mirror size, you can get a wider field of view.



Bright, protected headlights

Bright, protected headlights are positioned for exceptional visibility.



Expansion bellows

The expansion bellows absorbs vibration and reduces noise generated from the exhaust gas system and also extends the life cycle of exhaust gas system.



OPSS (Operator Presence Sensing System)

Control of mast tilting, lifting and lowering is not possible through operation of the appropriate control when the operator is not in the seated position. (Option)



Greece inlet

To facilitate the steering axle grease was applied remote type.

Centralized design for easy service!

An ideal arrangement of component parts ensures easy accesses and conveniences for the maintenance.



Large engine hood
Highly accessible engine compartment assures fast and efficient maintenance.



Easy change air cleaner
The air filter is readily accessible for cleaning or replacement.



Cabin tilting automatic system
Cabin tilting automatic system makes servicing of all power train components quick and easy. An electrically assisted hydraulic actuated cylinder tilts operator cabin to left side about 54 degrees for easy access to inside of truck components.



* Some of the photos may include optional equipment.



Cabin air fresh filter
The internal pressure is maintained to be slightly higher than that of outside to exclude dust and to reduce noise levels.



Mechanic friendly fuel filter replacement
Highly accessible engine compartment allows for quick replacement of filters.



Electrically monitored air filter
Air cleaner sensor alerts the operator of a clogged air filter and allows replacement before damage.



Compact fuse box for easy inspection



Maintenance free battery



Easy-to-access reservoir tank



Large tool box
Additional tool box located in machine side for operator's convenience.



Wing cover locking system

Mast Specification (Hook/Shaft Type)

| Model | Mast Type | Maximum Fork Height (mm) | | Overall Height (mm) | | | | | | Free Lift (mm) | | | | Tilt Angle (deg) | | Load Capacity without side shift at 600mm LC(kg) | | Load Capacity with side shift at 600mm LC(kg) | | Truck Weight (Unloaded) (kg) | | |
|------------|---------------------------|--------------------------|-------|---------------------|-------|----------|-------|-----------------------|-------|------------------------|-------|------|-------|------------------|-----|--|-------|---|-------|------------------------------|-------|-------|
| | | | | Lowered | | Extended | | Without Load Backrest | | With Std Load Backrest | | | | | | | | | | | | |
| | | Hook | Shaft | Hook | Shaft | Hook | Shaft | Hook | Shaft | Hook | Shaft | Hook | Shaft | Fwd | Bwd | Hook | Shaft | Hook | Shaft | Hook | Shaft | |
| 70D-7E ACE | 2 Stage limited free lift | *V300 | 3030 | 3030 | 2515 | 2515 | 4211 | - | 4320 | 4275 | 140 | - | 140 | 140 | 15 | 10 | 7000 | 7000 | 7000 | - | 9871 | 9886 |
| | | V330 | 3330 | 3330 | 2665 | 2665 | 4511 | - | 4620 | 4575 | 140 | - | 140 | 140 | 15 | 10 | 7000 | 7000 | 7000 | - | 9918 | 9966 |
| | | V350 | 3530 | 3530 | 2765 | 2765 | 4711 | - | 4820 | 4775 | 140 | - | 140 | 140 | 15 | 10 | 7000 | 7000 | 7000 | - | 9950 | 9965 |
| | | V370 | 3730 | 3730 | 2865 | 2865 | 4911 | - | 5020 | 4975 | 140 | - | 140 | 140 | 15 | 10 | 7000 | 7000 | 7000 | - | 9982 | 9996 |
| | | V400 | 4030 | 4030 | 3015 | 3015 | 5211 | - | 5320 | 5275 | 140 | - | 140 | 140 | 15 | 10 | 7000 | 7000 | 6900 | - | 10038 | 10052 |
| | | V450 | 4530 | 4530 | 3315 | 3315 | 5711 | - | 5820 | 5775 | 140 | - | 140 | 140 | 15 | 10 | 7000 | 7000 | 6700 | - | 10266 | 10280 |
| | | V500 | 5030 | 5030 | 3565 | 3565 | 6211 | - | 6320 | 6275 | 140 | - | 140 | 140 | 15 | 10 | 7000 | 7000 | 6450 | - | 10345 | 10360 |
| | | V550 | 5530 | 5530 | 3815 | 3815 | 6711 | - | 6820 | 6775 | 140 | - | 140 | 140 | 15 | 10 | 6750 | 6900 | 6300 | - | 10425 | 10439 |
| | V600 | 6030 | 6030 | 4065 | 4065 | 7211 | - | 7320 | 7275 | 140 | - | 140 | 140 | 15 | 10 | 6600 | 6700 | 6100 | - | 10503 | 10518 | |
| | 3 Stage full free lift | TS/TF450 | 4560 | 4560 | 2565 | 2565 | 5765 | - | 5805 | 5805 | 1360 | - | 1275 | 1320 | 15 | 10 | 7000 | 7000 | 6750 | - | 10474 | 10476 |
| TS500 | | 5060 | 5060 | 2765 | 2765 | 6265 | - | 6305 | 6305 | 1560 | - | 1475 | 1520 | 15 | 10 | 7000 | 6900 | 6600 | - | 10566 | 10568 | |
| TS560 | | 5600 | 5600 | 2965 | 2965 | 6805 | - | 6845 | 6845 | 1760 | - | 1675 | 1720 | 15 | 10 | 6900 | 6650 | 6400 | - | 10677 | 10679 | |
| TS600 | | 6060 | 6060 | 3165 | 3165 | 7265 | - | 7305 | 7305 | 1960 | - | 1875 | 1920 | 15 | 10 | 6700 | 6500 | 6200 | - | 10765 | 10766 | |

| Model | Mast Type | Maximum Fork Height (mm) | | Overall Height (mm) | | | | | | Free Lift (mm) | | | | Tilt Angle (deg) | | Load Capacity without side shift at 600mm LC(kg) | | Load Capacity with side shift at 600mm LC(kg) | | Truck Weight (Unloaded) (kg) | | |
|------------------------|---------------------------|--------------------------|-------|---------------------|-------|----------|-------|-----------------------|-------|------------------------|-------|------|-------|------------------|-----|--|-------|---|-------|------------------------------|-------|-------|
| | | | | Lowered | | Extended | | Without Load Backrest | | With Std Load Backrest | | | | | | | | | | | | |
| | | Hook | Shaft | Hook | Shaft | Hook | Shaft | Hook | Shaft | Hook | Shaft | Hook | Shaft | Fwd | Bwd | Hook | Shaft | Hook | Shaft | Hook | Shaft | |
| 80D-7E ACE | 2 Stage limited free lift | *V300 | 3040 | 3040 | 2675 | 2675 | 4348 | - | 4350 | 4375 | 150 | - | 150 | 150 | 15 | 10 | 8000 | 8000 | 8000 | 8000 | 11018 | 11006 |
| | | V330 | 3340 | 3340 | 2825 | 2825 | 4648 | - | 4650 | 4675 | 150 | - | 150 | 150 | 15 | 10 | 8000 | 8000 | 8000 | 8000 | 11067 | 11055 |
| | | V350 | 3540 | 3540 | 2925 | 2925 | 4848 | - | 4850 | 4875 | 150 | - | 150 | 150 | 15 | 10 | 8000 | 8000 | 8000 | 8000 | 11100 | 11088 |
| | | V370 | 3740 | 3740 | 3025 | 3025 | 5048 | - | 5050 | 5075 | 150 | - | 150 | 150 | 15 | 10 | 8000 | 8000 | 8000 | 8000 | 11132 | 11120 |
| | | V400 | 4040 | 4040 | 3175 | 3175 | 5348 | - | 5350 | 5375 | 150 | - | 150 | 150 | 15 | 10 | 8000 | 8000 | 8000 | 8000 | 11181 | 11169 |
| | | V450 | 4540 | 4540 | 3475 | 3475 | 5848 | - | 5850 | 5875 | 150 | - | 150 | 150 | 15 | 10 | 8000 | 8000 | 7700 | 7700 | 11396 | 11384 |
| | | V500 | 5040 | 5040 | 3725 | 3725 | 6348 | - | 6350 | 6375 | 150 | - | 150 | 150 | 15 | 10 | 8000 | 8000 | 7500 | 7500 | 11478 | 11466 |
| | | V550 | 5540 | 5540 | 3975 | 3975 | 6848 | - | 6850 | 6875 | 150 | - | 150 | 150 | 15 | 10 | 7850 | 7800 | 7300 | 7300 | 11559 | 11547 |
| | V600 | 6040 | 6040 | 4225 | 4225 | 7348 | - | 7350 | 7375 | 150 | - | 150 | 150 | 15 | 10 | 7600 | 7600 | 7100 | 7100 | 11641 | 11629 | |
| 3 Stage full free lift | TF450 | 4570 | 4570 | 2750 | 2750 | 5902 | - | 5880 | 5905 | 1418 | - | 1440 | 1415 | 15 | 10 | 8000 | 8000 | 7750 | 7750 | 11680 | 11654 | |

*Standard

Load Capacity

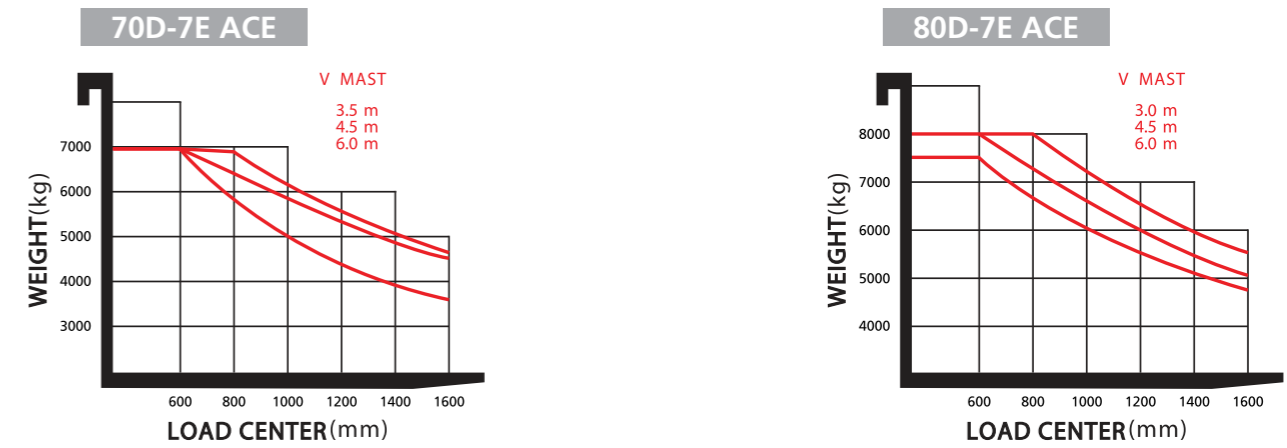

Various Attachments

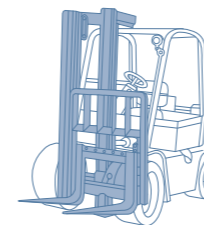

Side Shift

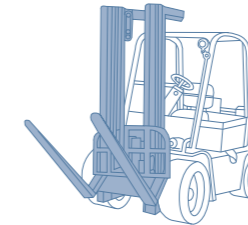

Hinged Fork

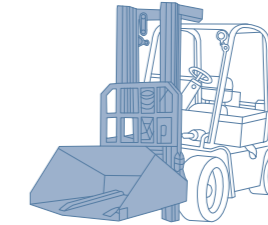

Hinged Bucket

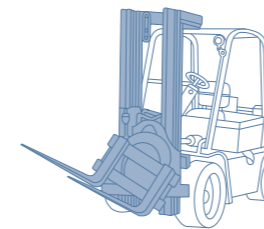

Rotating Fork

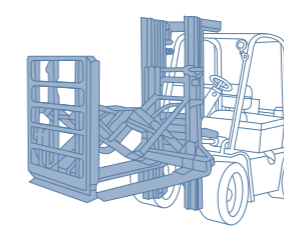

Push Pull

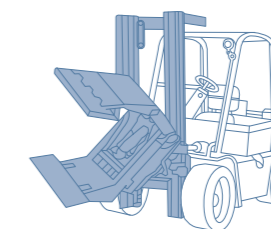

Rotating Roll Clamp

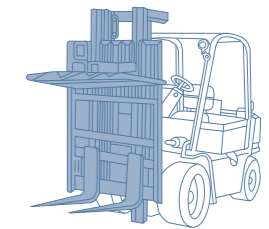

Load Stabilizer

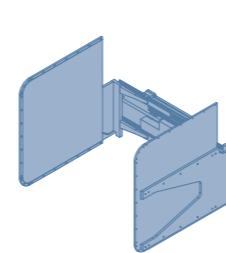

Carton Clamp

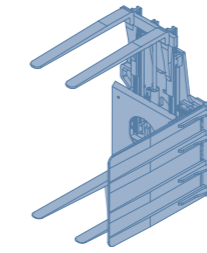

Pallet Invert

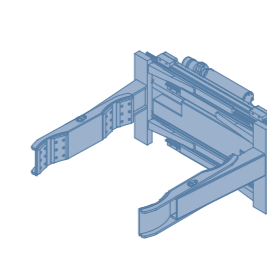

Drum Clamp

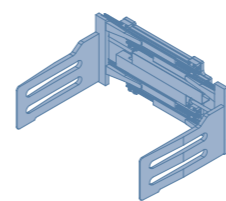

Bale Clamp

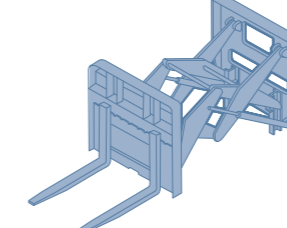

Load Extender

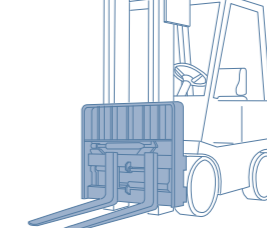

Fork Positioner

Dimension

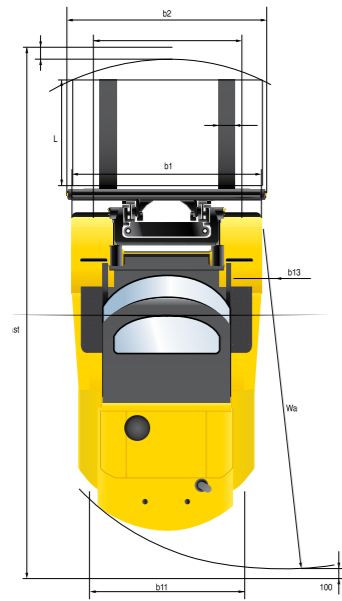
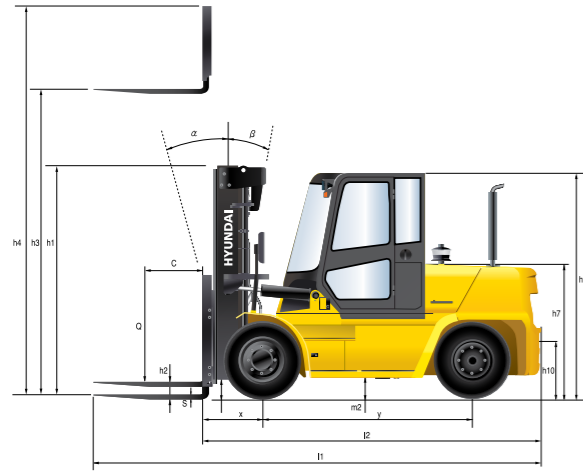

Specification

| Identification | | | |
|------------------|--|---------------------------------|------------------|
| 1.1 | Manufacturer | Hyundai | Hyundai |
| 1.2 | Manufacturer's type designation | 70D-7E ACE | 80D-7E ACE |
| 1.3 | Drive: electric (battery or mains),diesel,petrol,fuel gas,manual | DIESEL | DIESEL |
| 1.4 | Type of operation:hand,pedestrian,standing,seated,order-picker | seated | seated |
| 1.5 | Load capacity / rated load | kg 7,000 | kg 8,000 |
| 1.6 | Load center distance | c(mm) 600 | 600 |
| 1.7 | Load distance, center of drive axle to fork | x(mm) 615 | 690 |
| 1.8 | Wheelbase | y(mm) 2,300 | 2,500 |
| Weights | | | |
| 2.1 | Service weight | kg 9,886 | 11,006 |
| 2.2 | Axle loading, loaded front/rear | kg 14,867 / 2,019 | 16,928 / 2,078 |
| 2.3 | Axle loading, unloaded front/rear | kg 4,169 / 5,717 | 4,800 / 6,206 |
| Wheels, Chassis | | | |
| 3.1 | Tires:Pneumatic (P), Solid (S), Non-marking (N) | P | P |
| 3.2 | Tires size, front(∅x width) | 8.25-15-14PR | 9.00-20-14PR |
| 3.3 | Tires size, rear(∅x width) | 8.25-15-14PR | 9.00-20-14PR |
| 3.4 | Wheels, number front x rear (x=driven wheels) | 4 x / 2 | 4 x / 2 |
| 3.5 | Track width, front | b10 mm 1,580 | 1,632 |
| 3.6 | Track width, rear | b11 mm 1,604 | 1,700 |
| Basic Dimensions | | | |
| 4.1 | Mast / fork carriage tilt forward / backward (α xβ) degrees | 15 / 10 | 15 / 10 |
| 4.2 | Lowered mast height | h1 (mm) 2,515 | 2,675 |
| 4.3 | Free lift | h2 (mm) 140 | 145 |
| 4.4 | Lift height | h3 (mm) 3,030 | 3,040 |
| 4.5 | Extended mast height | h4 (mm) 4,320 | 4,375 |
| 4.6 | Overhead guard height | h6 (mm) 2,500 | 2,603 |
| 4.7 | Seat height / standing height | h7 (mm) 1,395 | 1,464 |
| 4.8 | Coupling height | h10 (mm) 425 | 493 |
| 4.9 | Overall length | l1 (mm) 4,820 | 5,000 |
| 4.10 | Length to face of forks | l2 (mm) 3,640 | 3,960 |
| 4.11 | Overall width (Frame) | b1 (mm) 2,087 | 2,190 |
| 4.12 | Fork dimensions (hook type) | s / e / l (mm) 65 x 150 x 1,200 | 70 x 180 x 1,200 |
| 4.13 | Fork carriage ISO 2328, class / type A,B | Class IV | Class IV |
| 4.14 | Fork-carriage width | b2 (mm) 2,068 | 2,268 |
| 4.15 | Ground clearance, loaded, under mast | m1 (mm) 195 | 250 |
| 4.16 | Ground clearance, centre of wheelbase | m2 (mm) 220 | 287 |
| 4.17 | Aisle width for pallets 1,000 x 1,200 crossways (L x W) | Ast (mm) 5,238 | 5,580 |
| 4.18 | Aisle width for pallets 800 x 1,200 lengthways (W x L) | Ast (mm) 5,438 | 5,780 |
| 4.19 | Turning radius | Wa (mm) 3,360 | 3,600 |
| 4.20 | Smallest pivot point distance | b13 mm 1,224 | 1,354 |
| Performance Data | | | |
| 5.1 | Travel speed, unloaded | km/h 33.8 | 35.0 |
| 5.2 | Lift speed, loaded / unloaded | mm/s 420 / 460 | 410 / 480 |
| 5.3 | Lowering speed, loaded / unloaded | mm/s 500 / 450 | 500 / 500 |
| 5.4 | Drawbar pull, loaded | kg 7,304 | 7,008 |
| 5.5 | Gradeability, Loaded | % 42.4 | 36.1 |
| 5.6 | Service brake | FOOT (Hydraulic) | FOOT (Hydraulic) |
| Engine | | | |
| 6.1 | Engine manufacturer / type | HMC D4DD | HMC D4DD |
| 6.2 | Engine power acc. to ISO 1585 | kW 73.5 | 73.5 |
| 6.3 | Rated speed | 1/min 2,300 | 2,300 |
| 6.4 | No. of cylinder / cubic capacity | cm ² 3,907 | 3,907 |
| 6.5 | Fuel consumption acc. To VDI cycle | ℓ /h 4.5 | 5.2 |
| Other Details | | | |
| 8.1 | Type of drive control | Full Auto | Power Shaft |
| 8.2 | Operating pressure (system / attach) | bar 185 | 210 |
| 8.3 | Oil volume (hydraulic) | ℓ 100 | 100 |
| 8.4 | Noise (at driver's ear according to DIN 12 053) | db(A) 82 | 85 |

Optional Items

· FORK (L x W x T) (mm)

HOOK TYPE

70D-7E ACE · 1,350 x 150 x 65 · 1,500 x 150 x 65 · 1,800 x 150 x 65
· 2,000 x 150 x 65 · 2,400 x 150 x 65

80D-7E ACE · 1,350 x 180 x 70 · 1,500 x 180 x 70 · 1,800 x 180 x 70
· 2,000 x 180 x 70 · 2,400 x 180 x 70

SHAFT TYPE

70D-7E ACE · 1,350 x 180 x 60 · 1,500 x 180 x 70 · 1,800 x 180 x 70
· 2,000 x 180 x 70 · 2,400 x 180 x 70

80D-7E ACE · 1,350 x 180 x 70 · 1,500 x 180 x 70 · 1,800 x 180 x 70
· 2,000 x 180 x 70 · 2,400 x 180 x 70

· TIRE SOLID, NON-MARKING

· SEAT ARM REST, HIP REST, GRAMMER

· CABIN & HEATER CABIN, AIRCON+HEATER

· MUFFLER HORIZONTAL

· MASTER SWITCH

· BEACON LAMP

· MCV 3-SPOOL / 4-SPOOL / 5-SPOOL

· INTEGRAL FORK POSITIONER CARRIAGE (SHAFT TYPE)

· INTEGRAL SIDE SHIFT CARRIAGE (SHAFT TYPE)

· INTEGRAL SIDE SHIFT WITH FORK POSITIONER CARRIAGE (SHAFT TYPE)

· OPSS (TRAVEL OR TRAVEL + MAST)

· REAR VIEW CAMERA

· LOAD INDICATOR

· 3STAGE FULL FREE LIFT DUAL FREE CYL TYPE

· WIDE CARRIAGE (2,190mm, HOOK TYPE)

(2,223mm, SHAFT TYPE)

FOR 70D-7E ACE